



## Rock Garden Boulders

### Ma = millions of years ago

1. Ellenburger Group, Lower Ordovician (477 Ma)
2. Town Mountain Granite, Precambrian (1,070 Ma)
3. Hickory Sandstone, Cambrian (515 Ma)
4. Coal Creek Serpentinite, Precambrian (1,326 Ma)
5. Edwards Limestone, Cretaceous (101 Ma)
6. Columnar Basalt, Cretaceous (87 Ma)
7. Carrizo Sandstone, Eocene (52 Ma)
8. Early Permian Reef, Wolfcampian (280 Ma)
9. Brecciated Limestone, Ordovician (460 Ma)
10. Red Bluff Granite, Precambrian (1,120 Ma)
11. Sierra Blanca Rhyolite, Eocene (36 Ma)

## Rock Garden Features

12. "Groundwater of Texas" Fountain
13. "Rivers Across Texas"
14. "Western Face of the Guadalupe Mountains" Wall

CRC

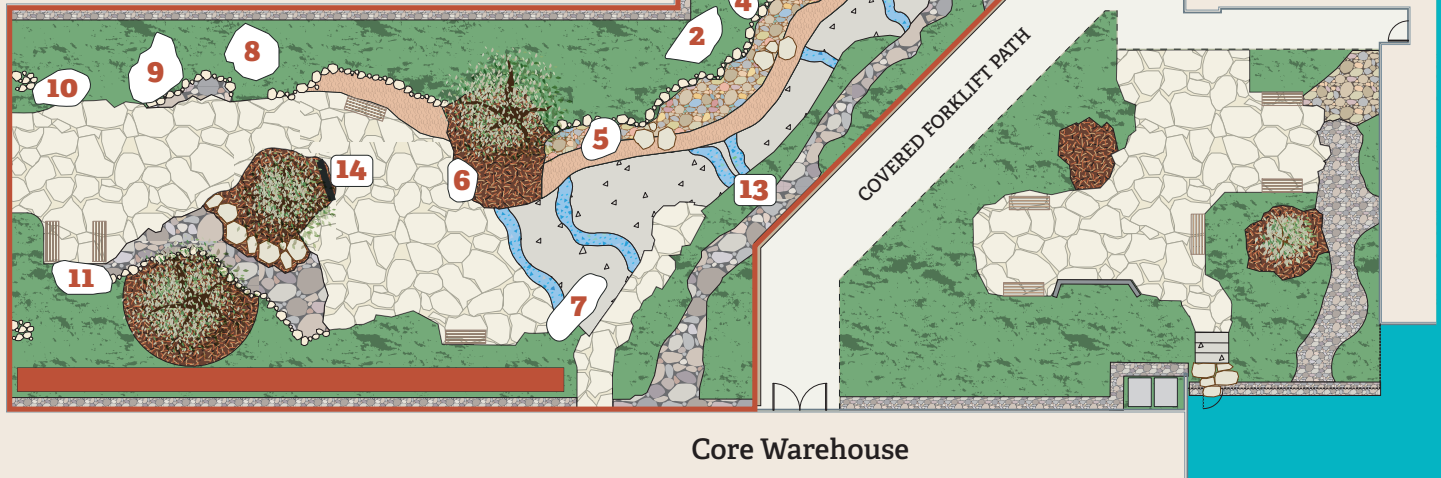

Core Warehouse

1



### Ellenburger Group

**Age:** Lower Ordovician (477 Ma)  
**Location:** Marble Falls, Texas  
**Rock Type:** Limestone (sedimentary)  
**Interesting Fact:** This rock is a significant oil and gas producer in Texas.

3



### Hickory Sandstone

**Age:** Cambrian (515 Ma)  
**Location:** Voca, Texas  
**Rock Type:** Sandstone (sedimentary)  
**Interesting Fact:** Sand from this formation is regularly used for drilling and hydraulic fracturing.

2



### Town Mountain Granite

**Age:** Precambrian (1,070 Ma)  
**Location:** Marble Falls, Texas  
**Rock Type:** Granite (igneous)  
**Interesting Fact:** This granite is used in the construction of the exterior of the Texas Capitol building.

4



### Coal Creek Serpentinite

**Age:** Precambrian (1,326 Ma)  
**Location:** Willow City, Texas  
**Rock Type:** Serpentinite (metamorphic)  
**Interesting Fact:** This rock gets its name from its color and texture, which resembles that of a snake.



5



## Edwards Limestone

**Age:** Cretaceous (101 Ma)  
**Location:** Hondo, Texas  
**Rock Type:** Limestone (sedimentary)  
**Interesting Fact:** The Edwards Limestone is from a famous Texas aquifer that also produces hydrocarbons in the deep subsurface.

10



## Red Bluff Granite

**Age:** Precambrian (1,120 Ma)  
**Location:** El Paso, Texas  
**Rock Type:** Granite (igneous)  
**Interesting Fact:** This granite formed deep in the crust along a 1-billion-year-old subduction zone.

6



## Columnar Basalt

**Age:** Cretaceous (87 Ma)  
**Location:** Knippa, Texas  
**Rock Type:** Basalt (igneous)  
**Interesting Fact:** This is a mantle-derived igneous rock with unique cooling joints.

11



## Sierra Blanca Rhyolite

**Age:** Eocene (36 Ma)  
**Location:** Sierra Blanca, Texas  
**Rock Type:** Rhyolite (igneous)  
**Interesting Fact:** This boulder formed during a time when volcano flows and calderas developed in West Texas.

7



## Carrizo Sandstone

**Age:** Eocene (52 Ma)  
**Location:** Poteet, Texas  
**Rock Type:** Sandstone (sedimentary)  
**Interesting Fact:** This sedimentary rock is formed from material that was originally part of the Rocky Mountains and eroded away.

12



## "Groundwater of Texas" Fountain

**Interesting Fact:** This fountain represents the nine major aquifers of Texas and is made from 1.3-billion-year-old marble (metamorphic).

8



## Early Permian Reef

**Age:** Wolfcampian (280 Ma)  
**Location:** El Paso, Texas  
**Rock Type:** Limestone (sedimentary)  
**Interesting Fact:** This rock comes from a fossilized reef that formed at the beginning of the world-famous Permian Basin.

13



## "Rivers Across Texas"

**Interesting Fact:** Texas has 14 major rivers and streams with a combined length of 80,000 miles.

9



## Brecciated Limestone

**Age:** Ordovician (460 Ma)  
**Location:** El Paso, Texas  
**Rock Type:** Limestone (sedimentary)  
**Interesting Fact:** This rock formed along a fault zone where earthquakes were common.

14



## "Western Face of the Guadalupe Mountains" Wall

**Interesting Fact:** This wall highlights Texas' highest mountain, which rises 8,751 ft above sea level.